

Creighton University
Omaha, Nebraska • Downtown Corridor

THE MIKE AND JOSIE HARPER CENTER FOR STUDENT LIFE AND LEARNING FOR PARTIES, BANQUETS AND MEETINGS.

WELCOME!

The University's new front door anchoring the East Campus, the Harper Center is a state-of-the-art building with meeting rooms, "smart classrooms," an auditorium, a ballroom, and several dining venues.

Ideal for business meetings, wedding receptions, and other special events, it is located off 20th Street, adjacent to the Law School and the Michael G. Morrison, S.J. Soccer Stadium.



CREIGHTON UNIVERSITY
602 N. 20TH STREET
OMAHA, NE 68178

PH: 402-280-3545
FAX: 402-280-1708

WWW.CREIGHTON.EDU/
HARPERCENTER

We welcome the opportunity to host your next conference, meeting, or special event at Creighton University.

Situated in the heart of downtown Omaha, Creighton offers easy access to the airport, hotels, restaurants and local entertainment.

Limited on-campus housing may be available during non-academic sessions.

FACILITIES & SERVICES

- 7000 square foot ballroom with ceiling mounted projectors and screens
- 500 seat auditorium
- Up to 17 meeting rooms of various sizes
- State of the art technology services
- Smoke-free environment
- Complimentary on-site parking
- Full coverage wireless network



DINING & ENTERTAINMENT

- Full service catering available
- Billy Blues Alumni Grill (sports grill)
- Bird Feeder (convenience shop)
- Brew Jay (coffee shop)
- Numerous food outlets on campus
- FitNest Fitness Center

SURROUNDING ATTRACTIONS

The Mike and Josie Harper Center puts you near:

- Old Market Historic District
- Qwest Center Omaha
- Joslyn Art Museum
- Fontenelle Forest Nature Center
- Omaha's Henry Doorly Zoo
- Lauritzen Gardens
- Rosenblatt Stadium
- Orpheum Theater
- Strategic Air and Space Museum
- 10 minutes from Eppley Airport

CONTACT US TODAY

To get started with your planning, please contact:

Jana Ammon
Campus Conference Coordinator
(402) 280-3545
JanaAmmon@Creighton.edu.

Creighton
UNIVERSITY



Lower Level (1)

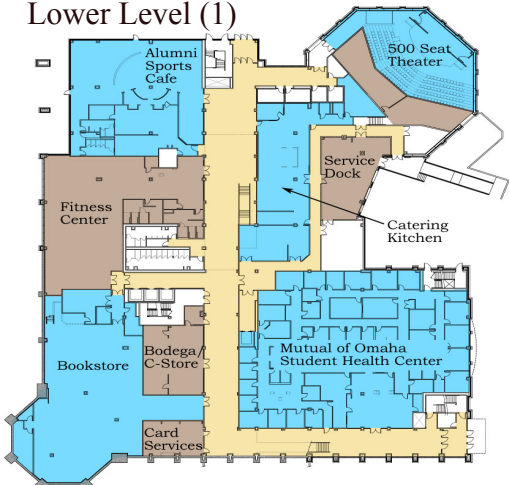

MEETING ROOM ACCOMMODATIONS

Some rooms can be divided into smaller sections

Room Number	Audience	Rounds	Standing
2060 (Level 2)	45	40	55
2066 (Level 2)	50	40	60
3023 entire (Level 3)	200	136	225
3026 (Level 3)	12	*	*
3027 entire (Level 3)	70	48	80
3028 entire (Level 3)	120	88	130
3029 entire (Level 3)	70	48	80
3048 (Level 3)	55	*	*
3053 (Level 3)	45	40	50
4006 (Level 4)	10	*	*
BALLROOM	600	400	700
Ballroom A	140	90	160
Ballroom B	140	90	160
Ballroom C	275	200	295
Auditorium	496	*	*

* not ideal for standing event

- All numbers are based on the maximum amount of seating.

- All Ballroom round tables can seat 10 people.

Ground Level (2)

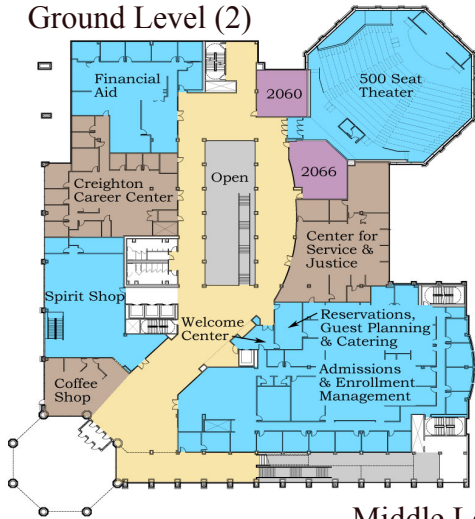

Middle Level (3)



Top Level (4)

